

VECTOR [®]



3 Load Cell,
3/10Klbs...400Klbs

Special features :

- ? Complies with NTEP regulations up to 1:10000 for class III L, Multi Cell
- ? Protection to IP67
- ? Designed for center link loading and compatibility with the Unlink or similar suspension systems
- ? Compatible with other sources
- ? Service lightning proof
- ? Available Option:
 - Service temperature range up to 120?



[248?]

- 6-wire circuit
- Stainless steel

Dimensions (in mm; 1mm = 0.03937 inches)

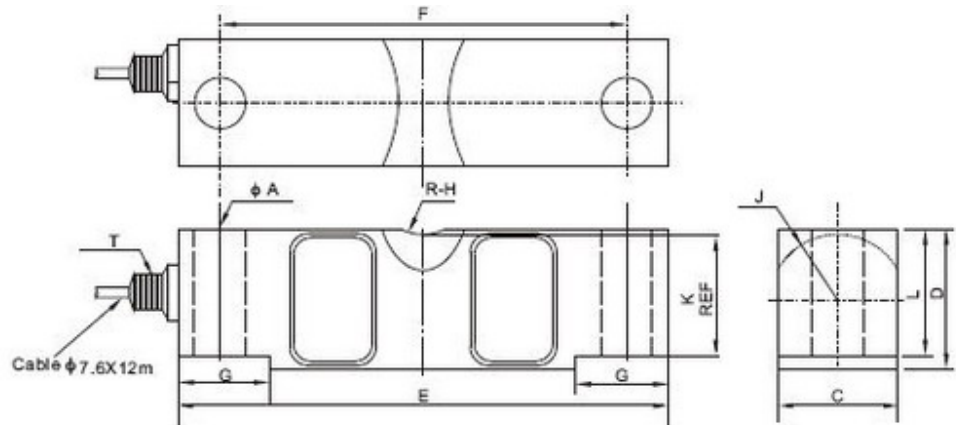

Capacity	A	C	D	E	F	G	R-H	J	K REF	L	T
kg/mm											
5...15,000	17.5	42.9	49.3	197	165.1	35.15	20	22.9	41.45	43.2	1/4-18 NPT
20,000	20.5	49.3	62	260.4	216	49	25	28.4	50.8	53.4	1/4-18 NPT
25,000...35,000	27	62	74.6	260.4	216	49	25	35	64.9	67.2	1/2-14 NPT
50,000	41	73.7	98	387.3	323.8	79.5	38	45.7	83.8	87.1	1/2-14 NPT
lb/inches											
10,000...25,000	0.68	1.69	1.94	7.75	6.50	1.38	0.75	0.90	1.63	1.70	1/4-18 NPT
40,000	0.81	1.94	2.44	10.25	8.50	1.93	1.00	1.12	2.00	2.10	1/4-18 NPT
50,000...75,000	1.06	2.44	2.94	10.25	8.50	1.93	1.00	1.37	2.54	2.65	1/2-14 NPT
SE*-100,000	1.06	2.44	3.44	10.25	8.50	1.93	1.00	1.37	2.54	2.65	1/2-14 NPT
100,000...125,000	1.62	2.90	3.86	15.25	12.75	3.13	1.50	1.80	3.30	3.43	1/2-14 NPT
200,000	1.62	3.80	5.80	19.25	15.25	4.00	2.00	2.37	4.44	5.12	1/2-14 NPT
300,000	2.12	5.80	5.80	22.00	17.00	5.00	2.50	4.00	4.44	5.12	1/2-14 NPT
400,000	2.12	5.80	5.80	22.00	17.00	5.00	3.00	5.00	7.22	5.12	1/2-14 NPT

VECTOR ®



Technical Data

Type		YZ102DB						
Accuracy class according to NTEP		NTEP 1:10000 class III L, Multi Cell						
Maximal capacity (E _{max})	t/lbs	5;10;15/ 10K;20K; 25K	20/ 40k	25;30;35/ 50K;60K; 75K	50/100K; 125K	90.8/ 200K	136.2 /300K	181.6/ 400K
Weight (G), approx.	kg	3.1	6	9	19	47	75	79
Sensitivity (C _n)	mV/V	3±0.25%						
Zero balance	mV/V	±0.06						
Temperature effect on sensitivity (TK _c) *	% of C _n /k	< ±0.0012						
Temperature effect on zero balance (TK _o)	% of C _n /k	<±0.0040						
Non-linearity (d _{lin}) *	%	<±0.030						
Repeatability (d _{rep}) *	%	<±0.017						
Hysteresis error (d _{hy}) *	%	< ±0.023						
Creep (d _{DR}) in 30 min.	%	< ±0.023						
Input resistance (RLC) [Red(+)-black(-)]	Ω	700 ±10						
Output resistance (RO) [green(+)-white(-)]	Ω	700±5						
Reference excitation voltage (U _{ref})	V(DC/AC)	0.5...24						
Maximal excitation voltage	V(DC/AC)	36						
Insulation resistance (R _{is})	GO	>2[50 VDC]						
Nominal temperature range	? [°F]	-10...+40[15...+105]						
Service temperature range	? [°F]	-30...+70[-20...+160]						
Storage temperature range	? [°F]	-50...+85[-60...+185]						
Safe load limit (EL)	% of C _n	150						
Breaking load (Ed)	% of C _n	300						
Protection class (IP) acc. to IEC529		IP67						
Material		Steel alloy						